

# Hippos (Sussita) Excavations 2010 – 11th Season Daily Log + Drawing

Date: 12 July 10 Area: NEC Manager: Schuler

Squares	XXYY99	YY/ZZ1/2	YY/ZZ4	ZZ99	
Loci	1219	1226	1226	1901	
Baskets	2332	2333	2334	2331	
Walls	W1261, W1266, W1288, W1236, W1297, W1298, W1902, W1903, W1904				
Floors	F1294				

- Shifted work in Square XX99/0 to XXYY99
  - Goal = Searching for intersection between W1266 and north to south wall on west side of putative street.
  - Starting elevation = 131.595
  - Ending elevation = 131.056
  - Soil is Horizon A/B
  - Possible drain channel in NE corner of square on the west side of W1298. Uncertain whether it is a drain, as there is little plaster in the mud. May also have been formed by compact dirt around a root or by an animal burrowing.
  - A plastered surface has been found running east to west and parallel to W1266 at a depth of 90cm. The top of this feature is level with the additions to W1298 and W1266. It too is covered with two layers of plaster, the exterior being of finer texture than the plaster next to the stones. Some curvature back toward W1266 at the west end of this new feature suggests that a small vat has appeared next to the NW interior corner of the intersection of W1298 and W1266. North to south, the vat is 1.4m. East to west, the vat is 1.55m. The east to west dimension may be greater and the west wall of the vat is broken by destruction tumble (part of a column shaft). Did not reach the bottom of the vat at the end of the day.

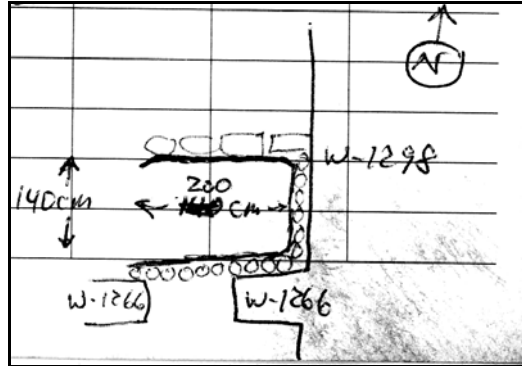

- Revealed the top of W1266 to the west edge of the square. As in ZZ99, the wall has a very flat top.

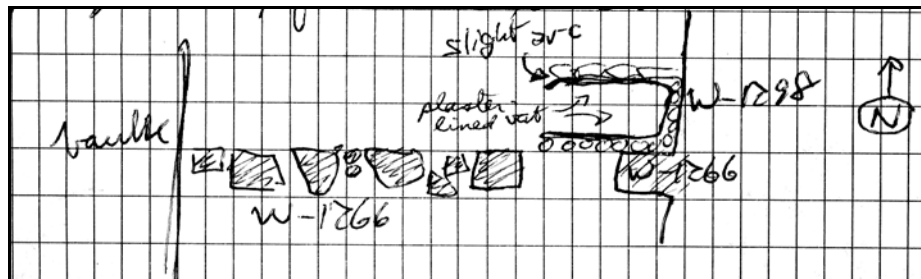

- Basket 2332 is from Locus 1219. That locus is topsoil after tractor work. In general, the contents are mixed material, fragments of Beisan and ROM jars, dating from 300 AD until 700 AD. Residual types are 1 SF (table amphora).
- Continued work in Square YY/ZZ1/2
  - Goal = Follow W1261 and south stylobate of paved plaza to the east.
  - Starting elevation = 130.703 (high)
  - Ending elevation = 130.739 (high)
  - Soil is Horizon B
  - Began clearing to plaza level working west to east. There was significant heavy destruction fill in the square.
  - Continued to reveal a large number of cornice pieces as in previous days.
  - A column drum was removed from 350cm north of W1261 and 80cm east of the stylobate. The drum is 85cm high and tapers from 34 to 37 cm in diameter. There are two holes running through the drum, a larger square hole (6 cm) about 20cm from the top and a smaller round hole (4 cm) roughly 16 cm from the top. The smaller hole was plugged at one end by plaster.

- At the end of the day, recovered the bottom of a Janus head flask near the base of the second column on the west side.

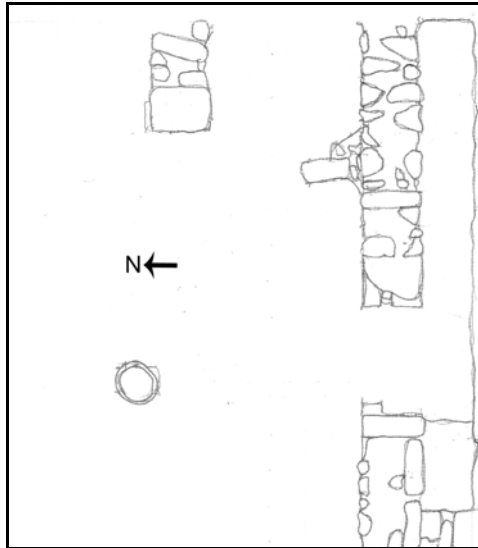

- Basket 2333 is from Locus 1226. That locus is below the level of L1219 in square YY/ZZ1/2. In general, the contents are little pottery, mostly Beisan jars, dating from 500 AD until 700 AD.
- Item: 446. Description: marble cornice (length 25 cm, width 5 cm, height 6 cm) found 137 cm north of w1261, 325 cm from east balk, 124 cm from surface.
- Item: 448. Description: marble cornice with two grooves and one rib, triangular from the side, 3 cm band or stripe across top (length 21 cm, width 5.5 cm at widest point, height 6.5 cm) found 92 cm north of w1261, 275 cm from east balk, 160 cm from surface.
- Item: 449. Description: marble cornice rectangular in shape (length 21 cm, width 3.5 cm, height 5.5 cm) excavated 101 cm north of w1261, 395 cm from east balk, 123 cm from surface.
- Item: 450. Description: carved limestone with two grooves and one rib (length 14.5 cm, width 5 cm, height 13 cm) found 221 cm north of w1261, 233 cm east of w1267, 161 cm from surface.
- Item: 451. Description: iron spike, 19 cm long. Looks like tip has recent break. Top is flat and rounded like an eye but there doesn't seem to be a hole. Found 125 cm south of w1288, 113 cm from east balk, 172 cm from surface.

- Item: 452. Description: marble cornice with two grooves and one rib (length 45 cm, width 6 cm, height 10 cm) retrieved 126 cm north of w1261, 340 cm from east balk, 145 cm from surface.
- Item: 453. Description: marble cornice with 4 cm band near top, one ribe and one groove (length 26 cm, width 5.5 cm, height 10 cm) removed 97 cm north of w1261, 377 cm from east balk, 149 cm from surface.
- Item: 454. Description: Janus flask, mold made, found on west side of column (6 cm tall, 4 cm wide at base) located 236 cm north of w1261, 504 cm east of w1267, 172 cm from surface.
- Continued work in Square YY/ZZ4
  - Goal = Follow W1288 and W1236 to east and clarify temporal relationship.
  - Starting elevation = 131.802 (east), 131.545 (west),
  - Ending elevation = 131.355
  - Soil is Horizon B, although there may be some change in soil color starting.
  - Continued to remove fill from inside the room.
  - A doorway in W1904 is now clearly visible as a second course of the door jamb is coming into view.
  - To the east of W1904 and to the south of the doorway are two threshold pieces placed next to each other and creating a staircase of sorts (like a circumstance of destruction tumble and not intentional placement.
  - Basket 2334 is from Locus 1226. That locus is below the topsoil of L1219 in square YY/ZZ4. In general, the contents are mixed material, various periods from early ROM to UMM; 1 lamp fragment, dating from 0 until 750 AD. Indicative types are ESA.
  - Item: 447. Description: stone foot, short, rounded and smooth (12 cm tall total, 07 cm tall foot only, 12 cm wide) retrieved 7 cm east of w1270, 16 cm south of w1288, 135 cm from surface.
- Opened YY0 and ZZ0
  - Goal = Expose rest of the paved plaza east of the church
  - Ending elevation = 131.200
  - Used the tractor to remove the top 1 meter of fill