

Hippos (Sussita) Excavations 2003 – 4th Season Daily Log + Drawing

Date: 13 July 2003 Area: NEC Manager: Schuler

Squares	B1	A2	B2	C3
Loci	L523, L507	L504	L501	L524
Baskets	PC1835 PC1839	PC1836	PC1837	PC1838
Walls	W520, W502			
Floors	F516			

- Continued work in Square B1
 - Starting elevation = 130.93
 - Ending elevation = 130.59
 - Pockets of an older buried soil were observed below the floor. This soil was redder in color and more compacted. It appeared to be more developed but not enough was observed to make a detailed examination. The lighter colored C horizon lies on the floor of the church. The lower soil dug easier in areas where the loculi for the reliquaries were located.
 - List of architectural items
 - 059 piece of marble (secondary use floor tile?) in void next to W520.

Basket 1835	Area NEC	Locus L523	Square B1	Opening elevation 130.932
Closing Elevation 130.592		Weight 0.4	Date 13-Jul-03	Manager Schuler
Yes Ceramic		Yes Plaster	No Human Bones	Loci Type destruction fill
No Ceramic non-pottery		No Architectural Item	No Iron	
Yes Tessera		No Lamp	No Lead	
Yes Glass		No Inscription	No Inscription	

Remarks

FW Bowl/Plate Base	FW Bowl/Plate Rim	FW Bowl/Plate Handle	FW Bowl/Plate Body Shard
0	0	0	0
FW Juglet Base	FW Juglet Rim	FW Juglet Handle	FW Juglet Body Shard
0	0	0	0
CCW Pot Rim	CCW Pot Handle	CCW Body Shard	CCW Casserole Base
0	0	13	0
CCW Casserole Handle	CCW Bowl Base	CCW Bowl Rim	CCW Bowl Handle
0	0	0	0
CCW Lid Rim	CCW Lid Handle	OCW Jar Base	OCW Jar Rim
0	0	0	0
OCW Other Base	OCW Other Rim	OCW Other Handle	OCW Other Body Shard
0	0	0	0
Lamp Rim	Lamp Handle	Lamp Body Shard	
0	0	0	

0 0 0

Analysis

tesserae:

1 cm -- 9 white, 1 black

plaster fragments including some with yellow background and red stripes

glass fragment

bone fragment:

LOC.	BONE	SIDE	SP.	B	NOTE
523	PC1835	Skull fragment	Frontal	Capra/Ovis	-

Basket	Area	Locus	Square	Opening elevation
1839	NEC	F507	B1	130.932
Closing Elevation		Weight	Date	Manager
130.592		3.85	13-Jul-03	Schuler
Yes Ceramic		Yes Plaster	Yes? Human Bones	
No Ceramic non-pottery		Yes Architectural Item	No Iron	Loci Type
Yes Tessera		No Lamp	No Lead	opus sectile floor
Yes Glass		No Inscription	No Inscription	

Remarks

from reliquary loculi; weight due to marble pieces

FW Bowl/Plate Base	FW Bowl/Plate Rim	FW Bowl/Plate Handle	FW Bowl/Plate Body Shard
0	0	0	0
FW Juglet Base	FW Juglet Rim	FW Juglet Handle	FW Juglet Body Shard
0	0	0	0
CCW Pot Rim	CCW Pot Handle	CCW Body Shard	CCW Casserole Base
0	0	28	0
CCW Casserole Handle	CCW Bowl Base	CCW Bowl Rim	CCW Bowl Handle
0	0	0	0
CCW Lid Rim	CCW Lid Handle	OCW Jar Base	OCW Jar Rim
0	0	0	0
OCW Other Base	OCW Other Rim	OCW Other Handle	OCW Other Body Shard
0	0	0	0
Lamp Rim	Lamp Handle	Lamp Body Shard	
0	0	0	11
			Lamp Base
			0

Analysis

marble: five broken pieces of white marble (2 fit together); one of red marble (part of lid for reliquary loculus)?

Plaster fragments: some red and yellow

tesserae:

1cm -- 20 white, 1 red

block of three white

4 bone fragments (one looks like piece of human spine -- sent out)

- o Excavated two voids in the floor (L507) of the north aisle east of the chancel screen. Both were a loculus for a reliquary. The reliquary and cover piece are missing. Both reliquary loculi go below the level of the previously identified F517 in the tomb room (elevation 130.72)
- o The loculus in the void (.69x.45) next to the east wall (W520) is formed by an L-shaped stone and by other stones forming a "U" against the wall. Plaster on

BBBBB

the wall behind the loculus suggests that the loculus is from a later phase of the church. The base of the loculus is dirt and is 39 cm below the level of the floor.

- The central void (90x65) contains a single carved stone (57x49) creating a loculus 31x32x17. The base of the loculus is part of the stone. Indications in the plaster above the loculus point to a cover of approx 57x29. A spinal bone in the debris of the loculus has been sent for identification.
- Resumed work in square A2 (L504)
 - Starting elevation = 131.33
 - Ending elevation = 130.93
- The soil is Horizon B (not C as one might expect): grayish brown (10YR 5/2) dry, very stony sandy loam, dark grayish brown (10YR 4/2) moist; very weak, coarse subangular blocky structure; 10 percent pebbles, 15 percent cobbles, 35 percent stones; irregular boundary.

Basket 1836	Area NEC	Locus L504	Square A2	Opening elevation 131.332	
Closing Elevation 130.932	Weight 2.5	Date 13-Jul-03	Manager Schuler	LocI Type destruction fill	
Yes Ceramic	Yes Plaster	No Human Bones			
Yes Ceramic non-pottery	No Architectural Item	No Iron			
Yes Tessera	No Lamp	No Lead			
Yes Glass	No Inscription	No Inscription			
Remarks					
1836A -- Byzantine/Umayyad rim of jar					
FW Bowl/Plate Base	FW Bowl/Plate Rim	FW Bowl/Plate Handle	FW Bowl/Plate Body Shard		
0	1	0	0		
FW Juglet Base	FW Juglet Rim	FW Juglet Handle	FW Juglet Body Shard	CCW Pot Base	
0	0	0	0	0	
CCW Pot Rim	CCW Pot Handle	CCW Body Shard	CCW Casserole Base	CCW Casserole Rim	
0	0	121	0	1	
CCW Casserole Handle	CCW Bowl Base	CCW Bowl Rim	CCW Bowl Handle	CCW Lid Base	
1	0	1	0	0	
CCW Lid Rim	CCW Lid Handle	OCW Jar Base	OCW Jar Rim	OCW Jar Handle	OCW Jar Body Shard
0	0	0	1	0	19
OCW Other Base	OCW Other Rim	OCW Other Handle	OCW Other Body Shard	Lamp Base	
0	0	0	0	0	
Lamp Rim	Lamp Handle	Lamp Body Shard			
0	0	0			
Analysis					
4 bone fragments – one large					
plaster fragments – some with dark red paint, some with yellow, one with 1/2cm band of light red					
tesserae:					
1 cm -- 2 white, 1 black					
one roof tile					

BBBBB

-
- Removed the last of the destruction debris to the floor. The synthronos, made of soft limestone and plaster is in deteriorated condition. There is a possible void in the synthronos next to the apse (W502).
 - Began work in B2 (L504 by elevation although the soil is more indicative of L501)
 - Starting elevation = 131.38
 - Ending elevation = 131.23
 - The soil is Horizon A and B:
 - A horizon - dark grayish brown (10YR 4/2) dry, very stony sandy loam, very dark brown (10YR 2/2) moist; weak fine granular structure; friable; 10 percent pebbles, 15 percent cobbles, 30 percent stones; clear wavy boundary.
 - B horizon - grayish brown (10YR 5/2) dry, very stony sandy loam, dark grayish brown (10YR 4/2) moist; very weak, coarse subangular blocky structure; 10 percent pebbles, 15 percent cobbles, 35 percent stones; irregular boundary.
-

Basket 1837	Area NEC	Locus L501	Square B2	Opening elevation 131.382
Closing Elevation 131.132	Weight 1.49	Date 13-Jul-03	Manager Schuler	Loci Type destruction fill
Yes Ceramic	Yes Plaster	No Human Bones		
Yes Ceramic non-pottery	No Architectural Item	No Iron		
Yes Tessera	No Lamp	No Lead		
No Glass	No Inscription	No Inscription		

Remarks

FW Bowl/Plate Base	FW Bowl/Plate Rim	FW Bowl/Plate Handle	FW Bowl/Plate Body Shard		
0	0	0	0		
FW Juglet Base	FW Juglet Rim	FW Juglet Handle	FW Juglet Body Shard	CCW Pot Base	
0	0	0	0	0	
CCW Pot Rim	CCW Pot Handle	CCW Body Shard	CCW Casserole Base	CCW Casserole Rim	
0	1	55	0	0	
CCW Casserole Handle	CCW Bowl Base	CCW Bowl Rim	CCW Bowl Handle	CCW Lid Base	
0	0	0	0	0	
CCW Lid Rim	CCW Lid Handle	OCW Jar Base	OCW Jar Rim	OCW Jar Handle	OCW Jar Body Shard
0	0	0	1	0	17
OCW Other Base	OCW Other Rim	OCW Other Handle	OCW Other Body Shard	Lamp Base	
0	0	0	0	0	
Lamp Rim	Lamp Handle	Lamp Body Shard			
0	0	0			

Analysis
2 roof tiles

Plaster with yellow paint (small fragment)

tesserae:
1 cm -- 7 black, 1 red, 1 yellow, 63 white
1 block

-
- Removed some of the destruction debris. Soil is dark and humus.
 - Continued work in Square C3
 - Starting elevation = 130.83 to 131.05
 - Ending elevation = 130.63 (stylobite =130.71)
 - The soil is Horizon C – light gray (10YR 7/2) dry, very stony sandy loam, grayish brown (10YR 5/2) moist; massive; firm, hard in places near the floor; 10 percent pebbles, 10 percent cobbles, 20 percent stones; assumed to be calcareous (by color).
 - List of architectural items . . .
 - 060A/B chancel screen post in two section with broken top hemisphere. Laying against CS2, angled downward to the north.
-

Basket 1838	Area NEC	Locus L524	Square C3	Opening elevation 130.832
Closing Elevation 130.632	Weight 0.88	Date 13-Jul-03	Manager Schuler	Locs Type plaster layer
Yes Ceramic	Yes Plaster	No Human Bones		
No Ceramic non-pottery	Yes Architectural Item	No Iron		
Yes Tessera	No Lamp	No Lead		
Yes Glass	No Inscription	No Inscription		
Remarks				
to pebble layer of floor				
FW Bowl/Plate Base	FW Bowl/Plate Rim	FW Bowl/Plate Handle	FW Bowl/Plate Body Shard	
0	0	0	0	
FW Juglet Base	FW Juglet Rim	FW Juglet Handle	FW Juglet Body Shard	CCW Pot Base
0	0	0	0	1
CCW Pot Rim	CCW Pot Handle	CCW Body Shard	CCW Casserole Base	CCW Casserole Rim
0	0	32	0	0
CCW Casserole Handle	CCW Bowl Base	CCW Bowl Rim	CCW Bowl Handle	CCW Lid Base
0	0	0	0	0
CCW Lid Rim	CCW Lid Handle	OCW Jar Base	OCW Jar Rim	OCW Jar Handle
0	0	0	0	0
OCW Other Base	OCW Other Rim	OCW Other Handle	OCW Other Body Shard	Lamp Base
0	0	0	0	0
Lamp Rim	Lamp Handle	Lamp Body Shard		
1	0	0		
Analysis				
2 bones				
1 glass fragment				
tesserae:				
1 cm -- 2 red and 6 white				
4x4 block (white)				
2 plaster fragments				

- Excavated to the base level of the columns

- Revealed a stylobate of stones between the columns.
- Some indications of a possible mud/dirt floor at the level of the stylobate

Observations

- Transference of the rituals to another location may be indicated by the empty loculi, although robbery cannot be ruled out. If the former, then only ritual at the tomb continued to the end (cp. Oil lamp found in tomb room in 2002).
- The reliquaries, as the floor (F516), belong to a later phase of the church.

Daily Drawing 13 July

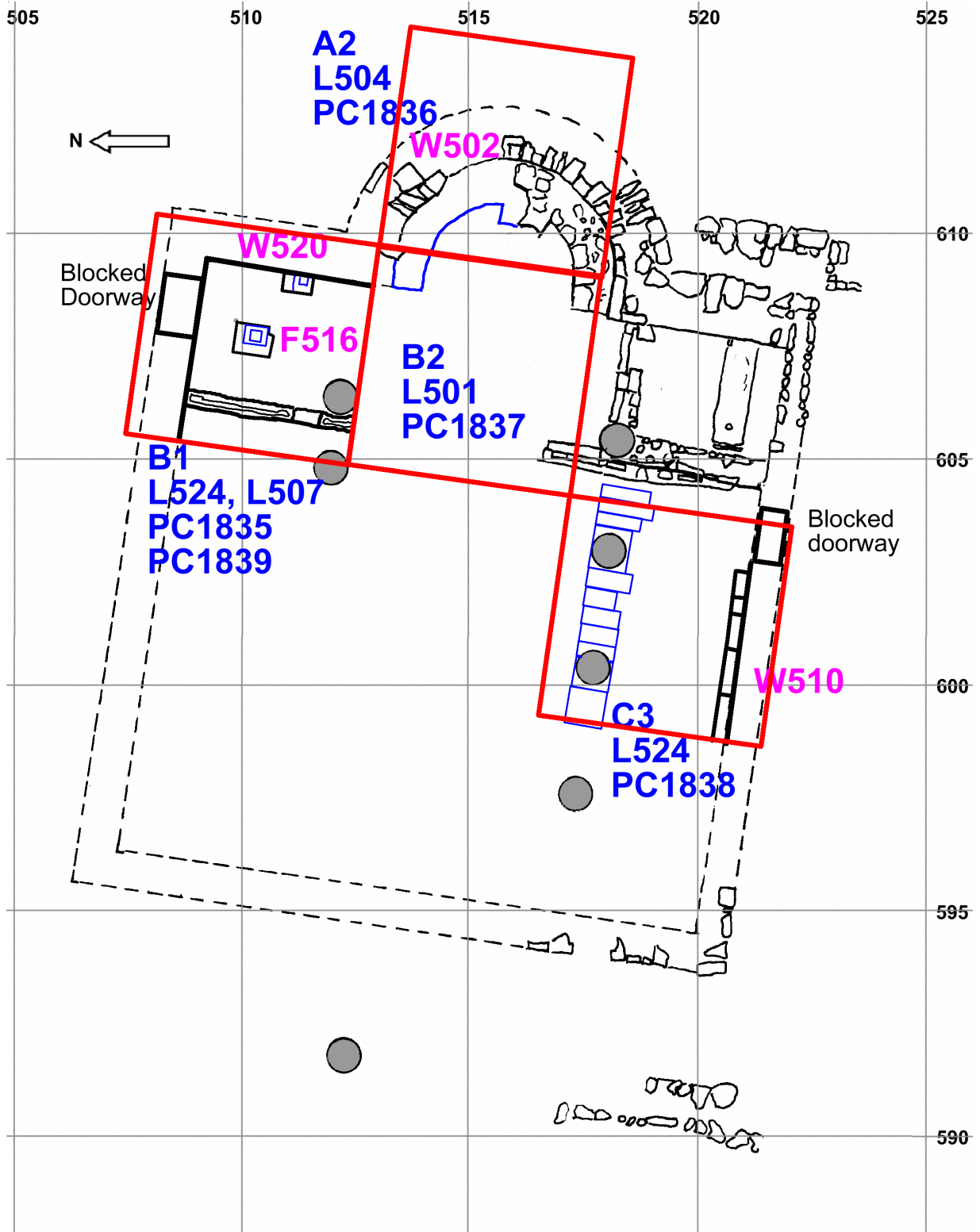

BBBBB