

Hippos (Sussita) Excavations 2003 – 4th Season Daily Log + Drawing

Date: 15 July 2003 Area: NEC Manager: Schuler

Squares	B2	C3	C3
Loci	L504	L524	L525
Baskets	PC1842	PC1843	PC1844
Walls	W510, W514		
Floors	F516, F526		

- Continued work in Square B2
 - Starting elevation = 131.09
 - Ending elevation = 130.95
 - The soil is Horizon B: grayish brown (10YR 5/2) dry, very stony sandy loam, dark grayish brown (10YR 4/2) moist; very weak, coarse subangular blocky structure; 10 percent pebbles, 15 percent cobbles, 35 percent stones; irregular boundary.
 - List of architectural items
 - 063 small marble cornice fragment

Basket 1842	Area NEC	Locus L504	Square B2	Opening elevation 131.092
Closing Elevation 130.952	Weight 2.7	Date 15-Jul-03	Manager Schuler	Loci Type destruction fill
Yes Ceramic	Yes Plaster	No Human Bones		
Yes Ceramic non-pottery	Yes Architectural Item	No Iron		
Yes Tessera	No Lamp	No Lead		
No Glass	No Inscription	No Inscription		

Remarks
1842A -- Hellenistic Casserole Rim

FW Bowl/Plate Base	FW Bowl/Plate Rim	FW Bowl/Plate Handle	FW Bowl/Plate Body Shard
0	2	0	0
FW Juglet Base	FW Juglet Rim	FW Juglet Handle	FW Juglet Body Shard
0	1	0	0
CCW Pot Base	CCW Pot Rim	CCW Pot Handle	CCW Pot Body Shard
0	1	0	0
CCW Casserole Base	CCW Casserole Rim	CCW Casserole Handle	CCW Casserole Body Shard
0	0	0	0
CCW Bowl Base	CCW Bowl Rim	CCW Bowl Handle	CCW Bowl Body Shard
0	0	0	0
OCW Jar Base	OCW Jar Rim	OCW Jar Handle	OCW Jar Body Shard
0	1	3	12
OCW Other Base	OCW Other Rim	OCW Other Handle	OCW Other Body Shard
0	0	0	0
Lamp Base	Lamp Rim	Lamp Handle	Lamp Body Shard
0	0	0	0

Analysis
2 roof tile fragments
plaster fragments

tesserae:

1 cm -- 46 white, 4 red, 14 black

1.5 cm -- 3 white

3 blocks (black and white)

-
- Removed rubble to floor level and cleaned most of B2
 - Cleaned A2
 - Most stone in the floor pattern are missing. But there seems to be a similar opus sectile pattern on the north side of the chancel as on the south (partial reconstruction possible).
 - There are three openings in the chancel screen: north of CN1, south of CS1, and in the center.
 - One stone off center has an inscribed section: a rectangle that narrows slightly from right to left (look for parallels)
 - Continued work in C3
 - Starting elevation = 130.63
 - Ending elevation = 130.63
 - The soil is Horizon C – light gray (10YR 7/2) dry, very stony sandy loam, grayish brown (10YR 5/2) moist; massive; firm, hard in places near the floor; 10 percent pebbles, 10 percent cobbles, 20 percent stones; assumed to be calcareous (by color).
-

Basket 1843	Area NEC	Locus L524	Square C3	Opening elevation 130.632	
Closing Elevation 130.632	Weight 1.01	Date 15-Jul-03	Manager Schuler	Loci Type mosaic floor	
Yes Ceramic	Yes Plaster	No Human Bones			
No Ceramic non-pottery	No Architectural Item	No Iron			
Yes Tessera	No Lamp	No Lead			
Yes Glass	No Inscription	No Inscription			
Remarks					
pebble base and some fragments of floor					
FW Bowl/Plate Base	FW Bowl/Plate Rim	FW Bowl/Plate Handle	FW Bowl/Plate Body Shard		
0	0	0	0		
FW Juglet Base	FW Juglet Rim	FW Juglet Handle	FW Juglet Body Shard	CCW Pot Base	
0	0	0	0	0	
CCW Pot Rim	CCW Pot Handle	CCW Body Shard	CCW Casserole Base	CCW Casserole Rim	
0	0	23	0	0	
CCW Casserole Handle	CCW Bowl Base	CCW Bowl Rim	CCW Bowl Handle	CCW Lid Base	
0	0	0	0	0	
CCW Lid Rim	CCW Lid Handle	OCW Jar Base	OCW Jar Rim	OCW Jar Handle	OCW Jar Body Shard
1	0	0	0	2	12
OCW Other Base	OCW Other Rim	OCW Other Handle	OCW Other Body Shard	Lamp Base	
0	0	0	0	0	
Lamp Rim	Lamp Handle	Lamp Body Shard			

BBBBB

0 0 0

Analysis

tesserae:

1 cm -- 14 red, 13 black, 69w hite
in plaster fragments at diverse angles
block of 13 (2 row white, 1 row black)

glass fragment

Basket	Area	Locus	Square	Opening elevation
1844	NEC	L525	C3	130.632
Closing Elevation		Weight	Date	Manager
130.632		0.05	15-Jul-03	Schuler
Yes Ceramic		No Plaster	No Human Bones	
No Ceramic non-pottery		No Architectural Item	No Iron	
Yes Tessera		Yes Lamp	No Lead	
No Glass		No Inscription	No Inscription	

Remarks

in plaster base of F526

1844A -- Oil lamp Roman 2-3c body

1844B -- Oil lamp tip with ash (different lamp from 1844a)

FW Bowl/Plate Base	FW Bowl/Plate Rim	FW Bowl/Plate Handle	FW Bowl/Plate Body Shard		
0	0	0	1		
FW Juglet Base	FW Juglet Rim	FW Juglet Handle	FW Juglet Body Shard	CCW Pot Base	
0	0	0	0	0	
CCW Pot Rim	CCW Pot Handle	CCW Body Shard	CCW Casserole Base	CCW Casserole Rim	
0	0	0	0	0	
CCW Casserole Handle	CCW Bowl Base	CCW Bowl Rim	CCW Bowl Handle	CCW Lid Base	
0	0	0	0	0	
CCW Lid Rim	CCW Lid Handle	OCW Jar Base	OCW Jar Rim	OCW Jar Handle	OCW Jar Body Shard
0	0	0	0	0	0
OCW Other Base	OCW Other Rim	OCW Other Handle	OCW Other Body Shard	Lamp Base	
0	0	0	0	1	
Lamp Rim	Lamp Handle	Lamp Body Shard			
0	0	1			

Analysis

lamp pieces are from two different lamps

tesserae:

1 cm -- 5 white

- Removed final layer of dirt from pebble base of mosaic floor.
- Recovered a 2nd/3rd century Roman oil lamp under the south door, under a stone that served as a base for the mosaic floor. As the lamp was in the plaster, it provides a terminus a quo for the building (not very helpful). The lamp was 49 cm west of the tomb wall (W514) and 17 cm below the threshold elevation (129.60).
- Bench construction carefully cleaned, revealing more edges of the mosaic

Observations

- The oil lamp might point to an early date for the church (4th century). The mosaics might point to a later date (late 6th century).

Daily Drawing 15 July

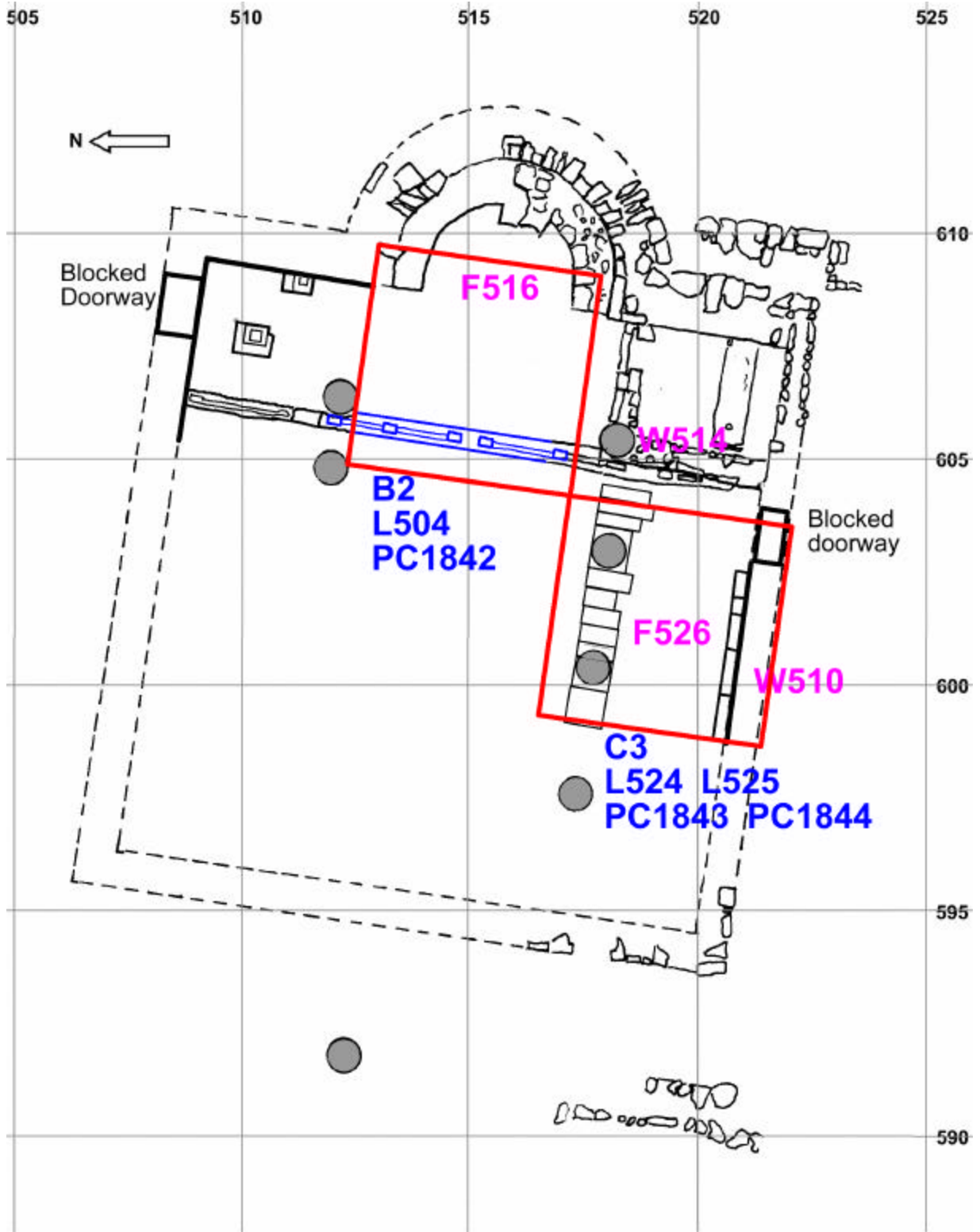

BBBBB