

Hippos (Sussita) Excavations 2003 – 4th Season Daily Log + Drawing

Date: 16 July 2003 Area: NEC Manager: Schuler

Squares	B2	B3	C3	D3
Loci	F516		L524	L501
Baskets	PC1845		PC1846	PC1847
Walls				
Floors	F516			

- Continued work in Square B2
 - Starting elevation = 130.95
 - Ending elevation = 130.93
 - The soil is Horizon B: grayish brown (10YR 5/2) dry, very stony sandy loam, dark grayish brown (10YR 4/2) moist; very weak, coarse subangular blocky structure; 10 percent pebbles, 15 percent cobbles, 35 percent stones; irregular boundary.

Basket	Area	Locus	Square		Opening elevation
1845	NEC	F516			130.952
Closing Elevation		Weight	Date	Manager	Loci Type
130.932		0.15	16-Jul-03	Schuler	opus sectile floor
Yes Ceramic		No Plaster		No Human Bones	
No Ceramic non-pottery		No Architectural Item		No Iron	
Yes Tessera		No Lamp		No Lead	
No Glass		No Inscription		No Inscription	
Remarks					
most floor tiles missing					
FW Bowl/Plate Base	FW Bowl/Plate Rim	FW Bowl/Plate Handle	FW Bowl/Plate Body Shard		
0	0	0	0		
FW Juglet Base	FW Juglet Rim	FW Juglet Handle	FW Juglet Body Shard	CCW Pot Base	
0	0	0	0	0	
CCW Pot Rim	CCW Pot Handle	CCW Body Shard	CCW Casserole Base	CCW Casserole Rim	
0	0	4	0	0	
CCW Casserole Handle	CCW Bowl Base	CCW Bowl Rim	CCW Bowl Handle	CCW Lid Base	
0	0	0	0	0	
CCW Lid Rim	CCW Lid Handle	OCW Jar Base	OCW Jar Rim	OCW Jar Handle	OCW Jar Body Shard
0	0	0	0	0	3
OCW Other Base	OCW Other Rim	OCW Other Handle	OCW Other Body Shard	Lamp Base	
0	0	0	0	1	
Lamp Rim	Lamp Handle	Lamp Body Shard			
0	0	0			
Analysis					
1 bone					
tesserae:					
1 cm -- 3 red, 4 black, 13 white					

- Removed the last of the destruction fill from F516. Thoroughly cleaned B1, B2, and A2
- In the NE corner of B1, one or two floor pieces are missing. The void revealed plaster against the north wall (W521) under the floor level. This is another confirmation that F516 comes from a second phase in the life of the church.
- Most tiles are missing in B2. In one section, a double ring of dark stone is of interest – perhaps decorative, perhaps worthy of investigation for a reliquary
- A rectangular stone on its side was revealed below floor level on the east/west axis of the church.
- Re-opened Square B3
 - Starting elevation = 131.23
 - Ending elevation = 130.93
 - Removed back fill from previous year and cleaned the tomb area.
- Finished final cleaning and sweeping of C3

Basket 1846	Area NEC	Locus L524	Square C3	Opening elevation 130.632	
Closing Elevation 130.632	Weight 0.72	Date 16-Jul-03	Manager Schuler	Loci Type mosaic floor	
Yes Ceramic	No Plaster	No Human Bones			
Yes Ceramic non-pottery	No Architectural Item	No Iron			
Yes Tessera	No Lamp	No Lead			
Yes Glass	No Inscription	No Inscription			
Remarks					
final cleaning of pebble base					
FW Bowl/Plate Base	FW Bowl/Plate Rim	FW Bowl/Plate Handle	FW Bowl/Plate Body Shard		
0	0	0	0		
FW Juglet Base	FW Juglet Rim	FW Juglet Handle	FW Juglet Body Shard	CCW Pot Base	
0	0	0	0	0	
CCW Pot Rim	CCW Pot Handle	CCW Body Shard	CCW Casserole Base	CCW Casserole Rim	
0	0	6	0	0	
CCW Casserole Handle	CCW Bowl Base	CCW Bowl Rim	CCW Bowl Handle	CCW Lid Base	
0	0	0	0	0	
CCW Lid Rim	CCW Lid Handle	OCW Jar Base	OCW Jar Rim	OCW Jar Handle	OCW Jar Body Shard
0	0	0	0	0	2
OCW Other Base	OCW Other Rim	OCW Other Handle	OCW Other Body Shard	Lamp Base	
0	0	0	0	0	0
Lamp Rim	Lamp Handle	Lamp Body Shard			
0	0	0			
Analysis					
1 roof tile					
2 glass fragments					
tesserae:					
1 cm -- 20 black, 6 red, 36 white					

- Opened Square D3
 - Starting elevation = 131.93
 - Ending elevation = 131.13
 - The soil is Horizon A dark grayish brown (10YR 4/2) dry, very stony sandy loam, very dark brown (10YR 2/2) moist; weak fine granular structure; friable; 10 percent pebbles, 15 percent cobbles, 30 percent stones; clear wavy boundary.

Basket 1847	Area NEC	Locus L501	Square D3	Opening elevation 131.932
Closing Elevation 131.132	Weight 1.95	Date 16-Jul-03	Manager Schuler	Locl Type destruction fill
Yes Ceramic	No Plaster	No Human Bones		
Yes Ceramic non-pottery	No Architectural Item	No Iron		
Yes Tessera	No Lamp	No Lead		
Yes Glass	No Inscription	No Inscription		

Remarks

1847A -- Galilean Local Bowl

1847B -- rim of jar

1847C -- rim Byzantine cooking pot (called A in notes)

FW Bowl/Plate Base	FW Bowl/Plate Rim	FW Bowl/Plate Handle	FW Bowl/Plate Body Shard
1	2	0	3

FW Juglet Base	FW Juglet Rim	FW Juglet Handle	FW Juglet Body Shard	CCW Pot Base
0	0	0	0	0

CCW Pot Rim	CCW Pot Handle	CCW Body Shard	CCW Casserole Base	CCW Casserole Rim
1	7	122	0	0

CCW Casserole Handle	CCW Bowl Base	CCW Bowl Rim	CCW Bowl Handle	CCW Lid Base
0	0	0	0	0

CCW Lid Rim	CCW Lid Handle	OCW Jar Base	OCW Jar Rim	OCW Jar Handle	OCW Jar Body Shard
0	0	0	1	4	32

OCW Other Base	OCW Other Rim	OCW Other Handle	OCW Other Body Shard	Lamp Base
0	0	0	0	0

Lamp Rim	Lamp Handle	Lamp Body Shard
0	0	0

Analysis

3 glass fragments

tesserae:

1 cm -- 22 white, 5 black

-
- Removed assorted destruction fill

Observations

- Will attempt some reconstruction in B2 with the many loose floor tiles, recreating the pattern of the right on the left.

Daily Drawing 16 July

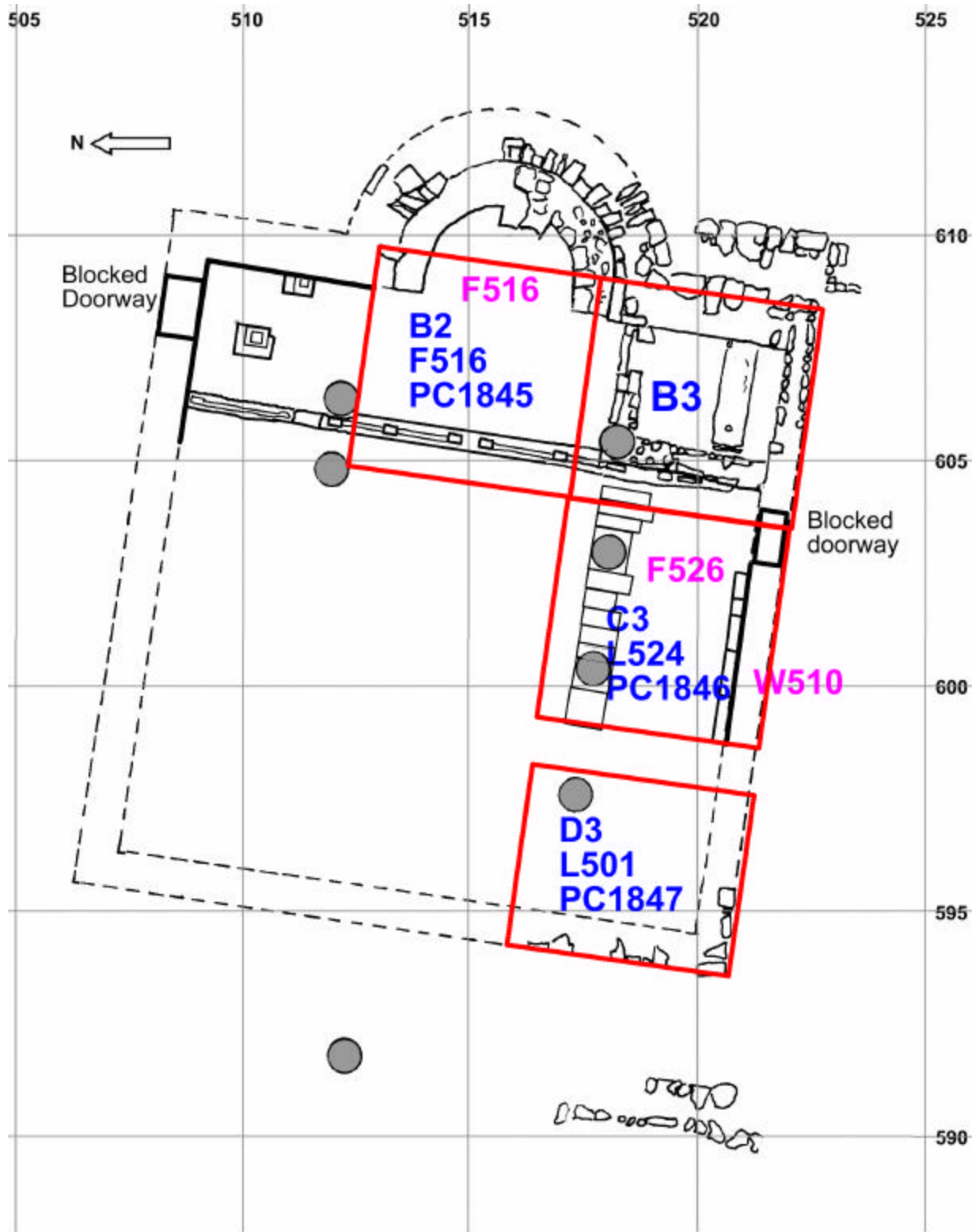

BBBBB