

Hippos (Sussita) Excavations 2003 – 4th Season Daily Log + Drawing

Date: 30 July 2003 Area: NEC Manager: Schuler

Squares	D0 and C0	C1
Loci	L536	L542
Baskets	PC1884	PC1885
Walls	W511, W521, W539, W540, W541	
Floors		

- Continued work in Square D0 and C0
 - Starting elevation = 131.53
 - Ending elevation = 130.63
 - Soil is Horizon B-- grayish brown (10YR 5/2) dry, very stony sandy loam, dark grayish brown (10YR 4/2) moist; very weak, coarse subangular blocky structure; 10 percent pebbles, 15 percent cobbles, 35 percent stones
 - PC1884 will be analyzed in 2004.
 - Followed the exterior of W540 to west of junction with W539. W539 may continue north of W540. There was insufficient time to clear enough rubble to see.
 - W540 seem to move slightly north as it proceeds west. At W539 its exterior is 4.1m from W521. At the NW corner of the church, the exterior of W540 is 4.65m away.
 - At 4.94m from the junction with W539 a column base/drum (diameter. 52) in situ protrudes partially for the exterior wall line. The column has been incorporated into the wall.
 - At the intersection of the N/S line of the exterior of W511 with W540, two column drums on their sides (laying north/south) seem to form a corner. Further excavation will clarify.
 - 3.65m from the junction of W539 and W540, a wall (W541) that overlays W540 veers slightly to the WSW (1.1m south at the exterior line of W511). It may continue to the west.

- Whether W511 continues north of W521 is unclear at this stage. A small basin installation (3/4 circle) at the seeming continuance of W511 north of W521 is suggestive. But the basin aligns a bit too far west. W541 and the basin may be indicative of later agricultural use of the ruins of the NE church
- Continued work in Square C1
 - Starting elevation = 130.93
 - Ending elevation = 130.68
 - Soil is Horizon B
 - PC1885 will be analyzed in 2004.
 - Exposed the complete run of the stylobate and five column bases. CN1-4 are on the stylobate. CN5 sits on a plaster base.
 - The column bases in the north run are most irregular. All five are significantly different in profile and elevation
 - Elevation
 - CN1-131.45
 - CN2- 131.55
 - CN3- 131.13
 - CN4- 131.07
 - CN5- 131.04
 - Although CN1 parallels CS1, the gaps between columns in the north aisle are shorter: 1.76-1.8 between each except CN3 and CN4 where the gap is double (3.55) Perhaps a column base is missing.

Observations

- The south aisle displays a consistent run of four column bases evenly spaced. The north aisle may have a run of six column bases covering the same distance. Either this inconsistency displays poor construction, a later and major repair/rebuilding, or a feature in square C1 yet to be revealed that requires a gap between CN3 and CN4.

Daily Drawing 30 July

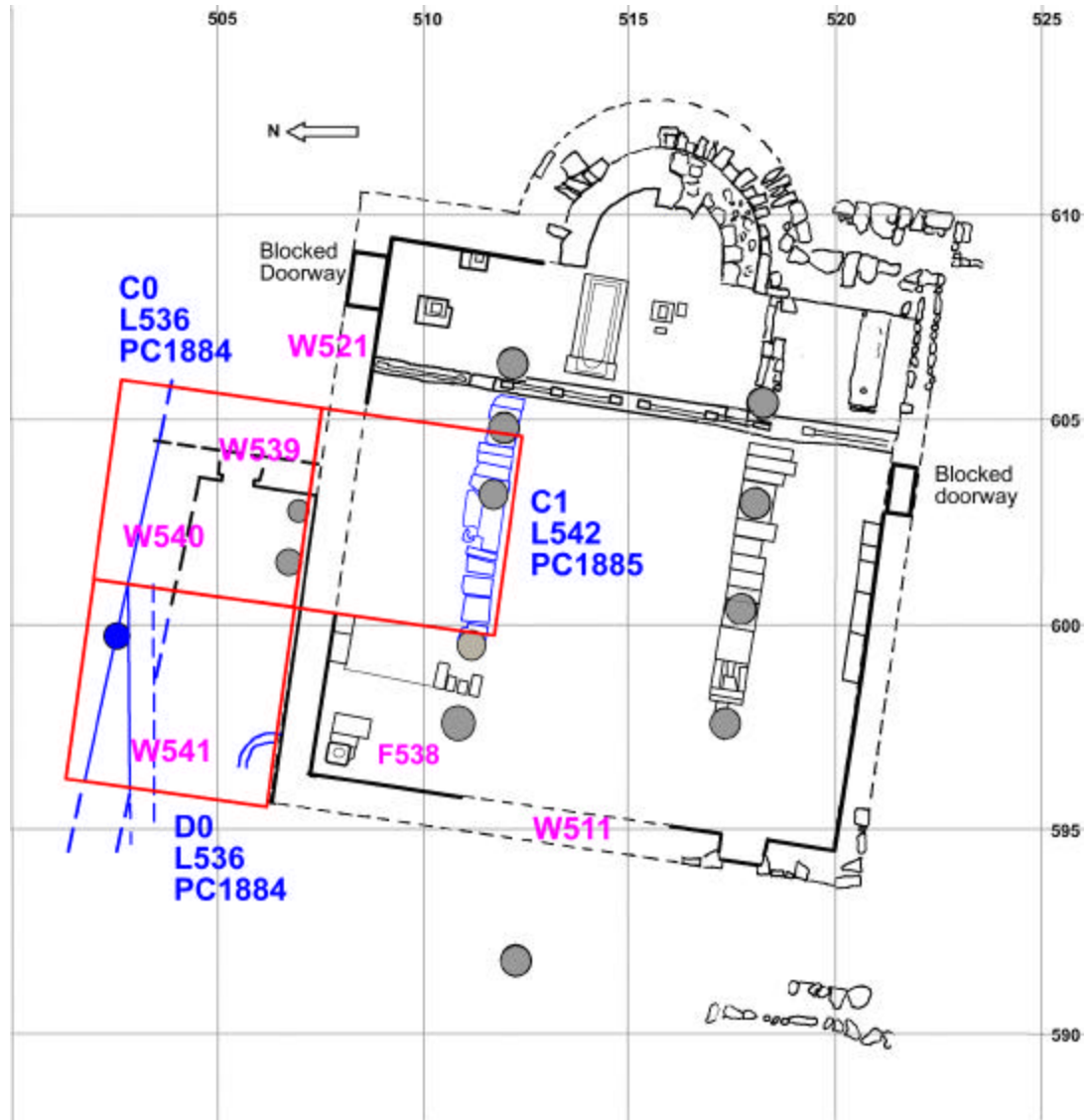

End of the Season

