

Hippus (Sussita) Excavations 2006 – 7th Season Daily Log + Drawing

Date: 3 July Area: NEC Manager: Schuler

Squares	B2	C/D2	C4	E0	E5	F4
Loci	Backfill from earlier work	Backfill from earlier work	L503	L563	L505	L563
Baskets	2033		2030	2032	2031	No basket
Walls						
Floors						

- Continued work in Square B2
 - Continued the process of removing backfill from the masonry tomb.
 - While working in L543 next to the sarcophagus, some human skeletal remains were recovered near the head end of the sarcophagus, including part of the jaw.
 - Backfill and portions of L543 not previously excavated were put through a 2mm sieve.
- Continued work in Square C/D4 (Nave)
 - Finished removing the layer of earth covering the felt.
- Continued work in Square C4
 - Starting elevation = 132.154
 - Ending elevation = 131.88
 - Soil is Horizon A
 - Initial layer of fill seems to indicate a roughly constructed building comprising most of the square. A passageway about 80 cm wide separates the building from W559 and W510. At the end of the day we identified the locus of this passageway as L587. Its fill seems to be horizon B.
- Continued work in Square E0
 - Starting elevation = 131.364
 - Ending elevation = 131.23
 - Soil is Horizon A

- The line of stones first noticed yesterday is a wall (W586). It consists of two lines of stones about 82 cm wide. It seems to be roughly perpendicular to the previously removed W541. Its top course is at 131.31.
- Both side of supposed W553 have also been discovered. Its top course is at 131.30.
- Continued work in Square E5
 - Starting elevation = 131.829
 - Ending elevation = 131.571
 - Continued removing surface soil and debris. Began to identify the line of W585.
 - Soil is Horizon A
- Began digging in Square F4
 - Starting elevation = 131.741
 - Ending elevation = 131.538
 - Broke through initial hard layer of packed earth.
 - There is a N/S line of stones on the west side of the square that may be a wall.

Observations

Daily Drawing

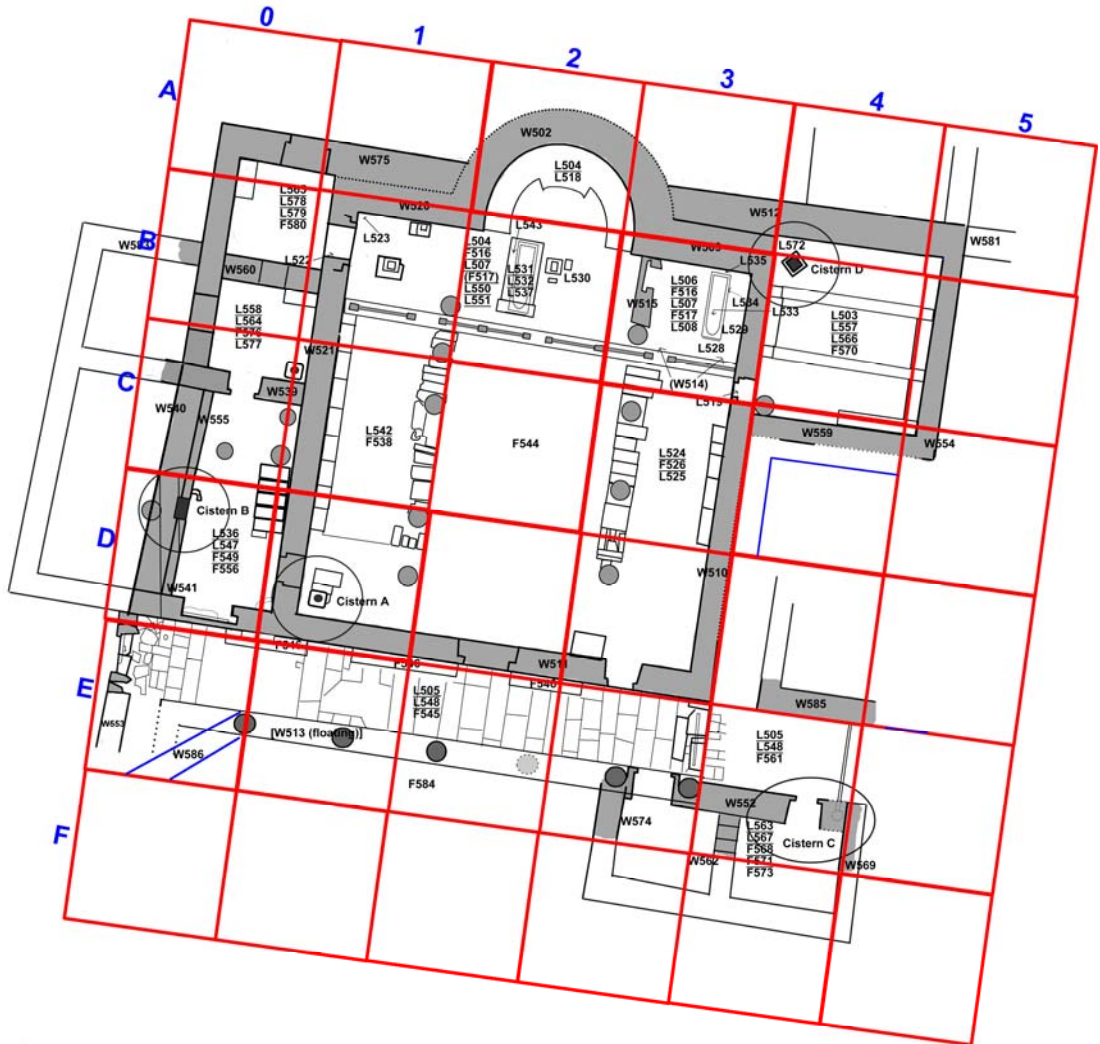

2m

Northeast Church Complex
Hippo 2006



M. Schuler