

Hippos (Sussita) Excavations 2006 – 7th Season Daily Log + Drawing

Date: 10 July Area: NEC Manager: Schuler

Squares	B2	C/D2	C4	E0	E1	E5	F4	B4
Loci	L590 F598		L503	L567	L563 W513	L548	L567	L596
Baskets	2062 2067		No basket	2061	2065 2066	2060	2063	2064
Walls	W513, W553, W585							
Floors	F544, F589							

- Continued work in Square B2
 - Starting elevation = 129.189 (floor); 129.310 (remains)
 - Ending elevation = 129.19
 - Soil is Horizon B.
 - Removed remainder of the fill. There was little pottery, bones, or lead toward the “head” end.
 - The floor is made of plaster with a hollow sound in the middle. We broke a 75cm section at the west end of the chamber. Under the plaster was a dark and porous under fill (thus the hollow sound) over bedrock from 1-6cm in depth. There were no small finds under the plaster.
- Continued conservation work in Square C/D2 (Nave)
 - Cleaning of nave continued.
 - Revealed a cross figure in the midst of the larger circles in the western segment of the floor.
- Began work in Square D4
 - Starting elevation = 132.08
 - Ending elevation = 131.939
 - Soil is Horizon A
 - Some lines of stones are beginning to emerge. But it is too early to be certain.
- Continued work in Square E0
 - Starting elevation = 130.493 (north street); 130.283 (northwest corner); 130.634 (stylobate); 131.300 (top of W553)

- Ending elevation = 130.478
- Soil is Horizon B
- Work on E0 was completed. No atrium west of the stylobate
- Began work in square E1
 - Starting elevation = 131.27
 - Ending elevation = 130.728
 - Soil is Horizon A
 - Removed floating W513 in E1. Very little pottery was recovered. From the wall.
- Continued work in Square E5
 - Starting elevation = 130.615 (street north end)
 - Ending elevation = 130.584 (street north end); 130.410 (street south end)
 - Soil is Horizon B
 - Finished clearing most of the street paving.
 - Identified a clear southern corner in W585 6.101m from the northerly corner. Another building continues to the south.
 - The street seems to abut the building, making the building older than the street. On the other hand the drainage for cistern C comes from under W585.
- Continued work in Square F4
 - Starting elevation = 131.145 (south east section)
 - Ending elevation = 130.729
 - Soil is Horizon B
 - Continued to lower the level; high volume of pottery recovered, along with animal bones.
- Began work on cistern D in Square B4
 - Starting elevation = 128.73 (reference point 131.061)
 - Ending elevation = 128.68
 - Soil is Horizon B (destruction fill)
 - Recovered jaw of dog, canine teeth and a partially intact pot.

Observations

- Met with Rona from the University of Haifa about the metals. The lead from the tomb is not from any identifiable item. While smooth on one side, it looked

like it had been poured out on soil on the other side. No clear shapes, places to fasten, etc.

- The “corner” piece was more promising, but of very poor quality of lead mixed with bronze. Cleaning required. Its function is uncertain.
 - The gold piece shows signs of repair and a stamp of a cross on the back.
-

Daily Drawing

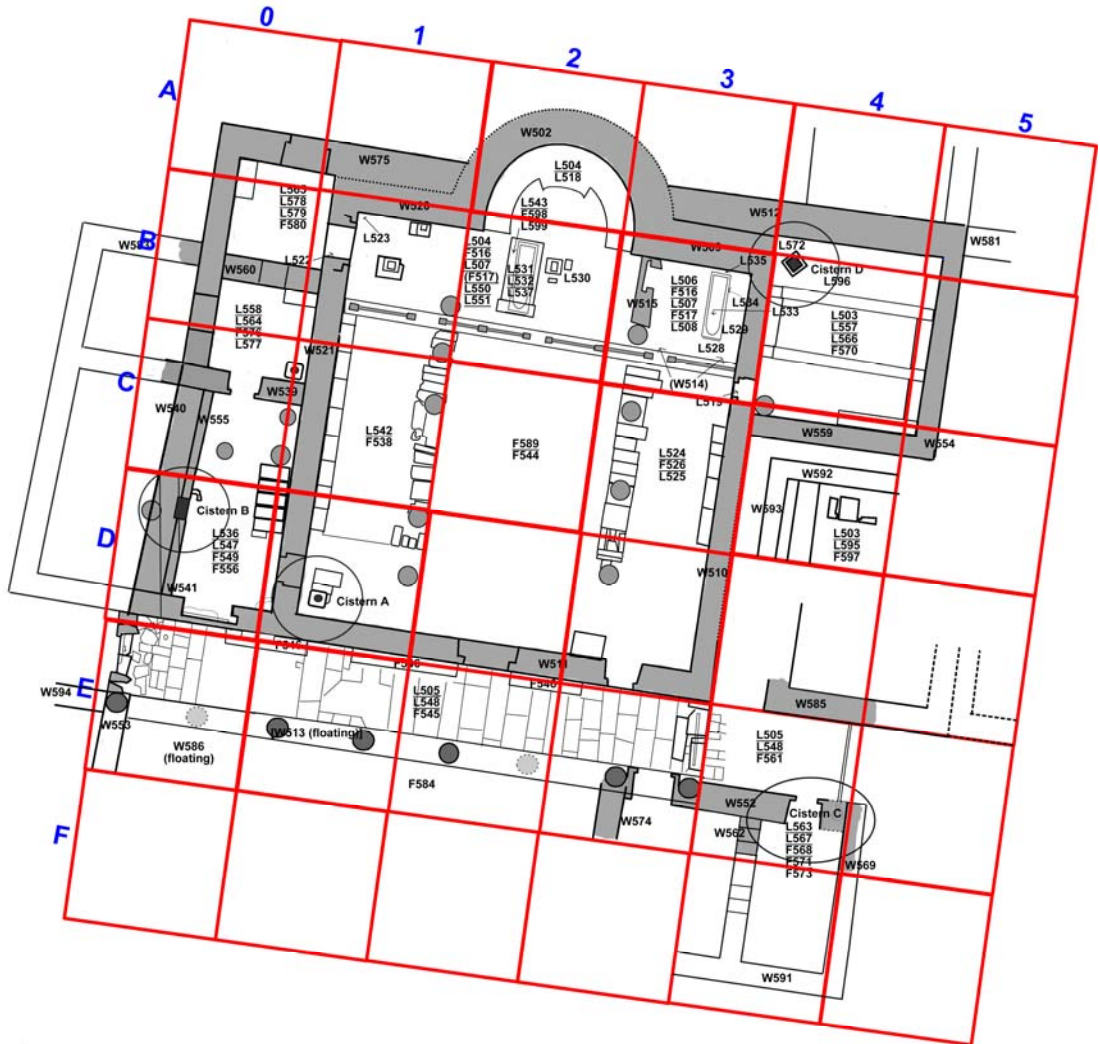

2m

Northeast Church Complex
Hippos 2006



M. Schuler