

Hippus (Sussita) Excavations 2006 – 7th Season Daily Log + Drawing

Date: 11 July Area: NEC Manager: Schuler

Squares	C/D2	D4	E1	E5	F4	B4
Loci		L503 L557	L567	L548	L567	L596
Baskets		2069 2073	2072	2068	2070	2071
Walls	W552, W562, W569, W585, W592, W593, W1201					
Floors	F516, F517, F544, F568, F589, F1202					

- Documentation of Masonry Tomb in Square B2
 - Detailed drawings prepared of masonry tomb
 - Elevations:

Plaster floor of the chamber east end	129.227
Plaster floor of the chamber west end	129.151
Bedrock lowest exposed level	129.053
 - Cross section examining floors on west end:

F516	130.854
Plaster layer of F517	130.650
Top course of masonry tomb	130.521
 - Cross section examining floors on east end

F516	130.941
Plaster of F517	130.760
Top course of masonry tomb	130.596
 - The gap between F516 and the plaster layer of F517 is 18-20cm. The gap between the plaster layer of F517 and to top course of masonry stones is 13-17cm. The plaster of F517 covers over the top course of the masonry tomb. The thickness of the covering stones is 18-22 cm.
 - Conclusion: The masonry tomb preceded the laying of the first floor of the church chancel (F517). As we have previously shown that the tomb of the exposed sarcophagus was contemporaneous with F517, either both tombs were installed when the church was built, or the masonry tomb preceded the construction of the church.
 - Summary of findings of human bones:

Square/Locus	Date	Basket	
B2 L543	3-Jul-06	2033	Left temporal bone 8cm distal tibia
B2 L543	4-Jul-06	2039	4cm distal radius 4cm of ? Scapula metatarsal bone distal metatarsal ? Upper extremity articular surface 2cm rib fragment fibula fragment ? Juvenile fibula fragment ? Juvenile skull fragment 3cm x 2cm 24 bone fragments
B2 L543	5-Jul-06	2044	Meta tarsal complete?adult 5 cm rib fragment 6 cm clavicle fragment ?navicular bone complete 19 bone fragments
B2 L590	5-Jul-06	2047	10 cm long bone fragment distal metatarsal 6 metatarsal bones ? Cuneiform bone skull fragment 2 vertbral body fragments metarsal bone large most likely male ?fibula distal fibula ? First cuneiform ? Cunieform bone 3 teeth 45 bone fragments
B2 L590	6-Jul-06	2051	7 upper extremity phalanges mixture of adult and juvenile 1 adult metacarpal 2 lower extremity metatarsal 1 lower extremity distal metatarsal 1 upper extremity distal phalange ? Juvenile 6 teeth 2 partial teeth 1 first metatarsal 2 navicular bones

			3 lunate bones of differing sizes ? Adult and juvenile 3 caral bones type unknown ? partial talus 56 bone fragments
B2 L590	9-Jul-06	2057	5 metatarsels 2 distal metatarsels 7 metacarpals 3 distal metacarpals 5 teeth 2 partial teeth 1 navicular bone 1 partial vertebra 9 bone fragments
B2 L596	10-Jul-06	2064	2 metacarpals 1 partial metacarpal 1 distal metacarpal 1 fragment of a metacarpal 1 rib fragment 9 bone fragments

- Discussion: The bone fragments in the area beside and under the sarcophagus represent at least two individuals. We recovered 3 lunate bones and there are only two in a human body. The bones also seem to represent both an adult and a juvenile. A large metatarsal bone likely belongs to a male. So we have remains from an adult male and a juvenile of indeterminate sex.
- We recovered no major bones, so we surmise that the two burials were removed leaving only fragments and the above listed items. Nevertheless, those who inserted the sarcophagus on top of the remains of a coffin intentionally raised the sarcophagus above the coffin about 20-25cm. That which was below was too revered to be crushed or to be swept away. We have to consider the possibility that the bodies interred below were mostly exhumed and placed into the sarcophagus along with the last burial. These final burials were revered with oil/wine through a lead pipe and no provision was made for ongoing reverence of what was below.
- Continued conservation work in Square C/D2 (Nave)

- Cleaning of nave continued.
 - Seem to have revealed a fragment of a lion . . . part of a zodiac?
 - In F544, the east half seems to be geometric. The west half has a section framed in counter clockwise swastika with disks for the zodiac.
 - The top floor (F589) has fan pattern.
 - Continued work in Square D4
 - Starting elevation = 131.939
 - Ending elevation = 131.639 (south of W1201); 131.055 (north of W1201)
 - Soil is Horizon A
 - Identified the wall perpendicular to W585. It is labeled W1201 and runs parallel to W510 2m to the south.
 - W593 is less certain. Perhaps with W592, W593 is part of a later animal pen.
 - Continued work in square E1
 - Starting elevation = 130.728
 - Ending elevation = 130.411
 - Soil is Horizon B
 - Removed last fill of E1. No pavers of the atrium to the west of the stylobate. Existence of a paved atrium remains uncertain.
 - Recovered a small Byzantine capital
 - Continued work in Square E5
 - Ending elevation = 130.584 (street north end); 131.389 (street south end)
 - Soil is Horizon B
 - Removed balk between E4 and E5.
 - Clarified the corner of W569. There is no wall to the south. W552 probably connected to W569
 - Cistern C was closed before these walls were built.
 - Continued work in Square F4
 - Starting elevation = 130.729 (south east section)
 - Ending elevation = 130.567 (F568 north end), 130.543 (F568 south end); 130.633 (section north of W562)
 - Soil is Horizon B
-

- Found a plaster floor similar to F568 north of W562. It had not been identified last year. Named this floor F1202. Major portions of a pot recovered from floor level.
 - High volume of pottery shards continue to be recovered.
 - Began work in square F3
 - Starting elevation = 131.521
 - Ending elevation = 131.48
 - Soil is Horizon A
 - Began to break the surface.
 - Continued work on cistern D in Square B4
 - Starting elevation = 128.68 (reference point 131.061)
 - Ending elevation = 128.59
 - Soil is Horizon B (destruction fill)
 - Additional small items were recovered: rat skull, mosaic block, shards.
 - Soil changing to larger grit.
 - Silt layer appearing.
-

Daily Drawing

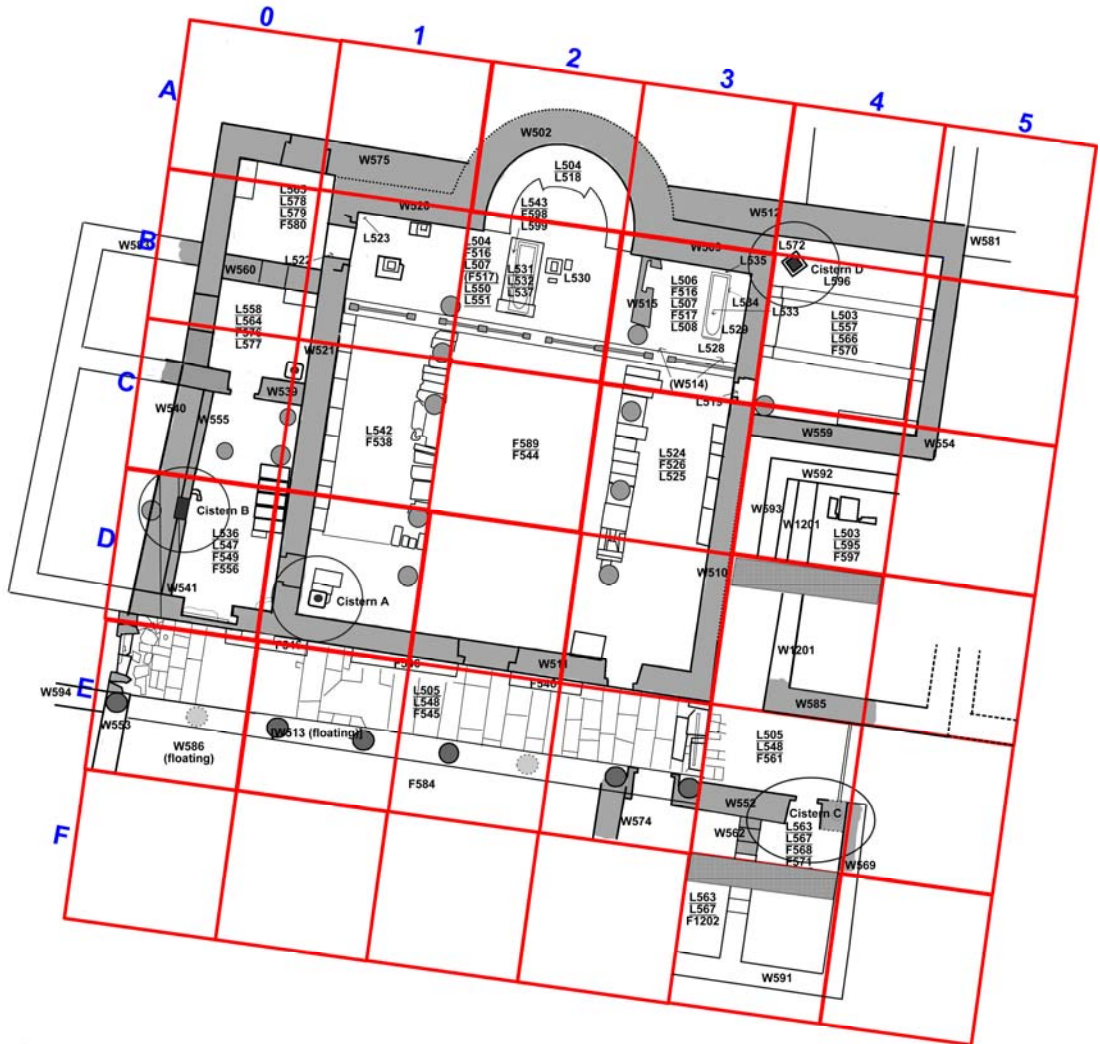

2m

Northeast Church Complex
Hippos 2006



M. Schuler