

Hippus (Sussita) Excavations 2006 – 7th Season Daily Log + Drawing

Date: 16 July Area: NEC Manager: Schuler

Squares	C/D2	D4	F3	F4
Loci		L557	L1206 L567	L1203
Baskets		2087	2089 2090	2088
Walls	W510, W574, W591, W1201			
Floors	F544, F589			

- Continued conservation work in Square C/D2 (Nave)
 - Cleaning of nave continued.
 - Repair continued on east end.
- Continued work in Square D4
 - Starting elevation = 130.980 (north of W1201)
 - Ending elevation = 130.760 (north of W1201 and east of ridge); 131.090 (top of ridge/low wall?)
 - Continued to clear area north of W1201.
 - There seems to be a low north/south ridge between W1201 and W510. It is 0.67m wide and about 0.35m high. It is 1.15m from the street.
 - Where this ridge abuts W1201 on the west side there is a basin of some sort (compare similar basin in D0). It is a rounded quarter circle of hard plaster (0.60 x 0.60m)
 - Soil is Horizon B
- Continued work in square F3
 - Starting elevation = 130.904 (south section); 130.862 (north section)
 - Ending elevation = 130.815 (inside room formed by W574 and W591); 130.510 (north of W574)
 - Soil is Horizon A to the north and B in the room.
 - Found a bench next to the west wall (W591) of same dimensions as in F4. The bench spans the north/south width of the room.
 - We seem to be close to the level of the plaster floor.

- In the SW corner of the square, there may be a wall going to the west (unnamed at this time). There does seem to be a north/south wall of poorer quality running to the north from W574. It is 2 meters from the west side of W591.
- Finished cleaning F4.
- Work on cistern D in Square B4 suspended due to evacuation of students
- Work on Square E8 suspended due to evacuation of students. Later in the season we may use the tractor to clear some of the top fill from the street in the E squares.

Observations

Daily Drawing

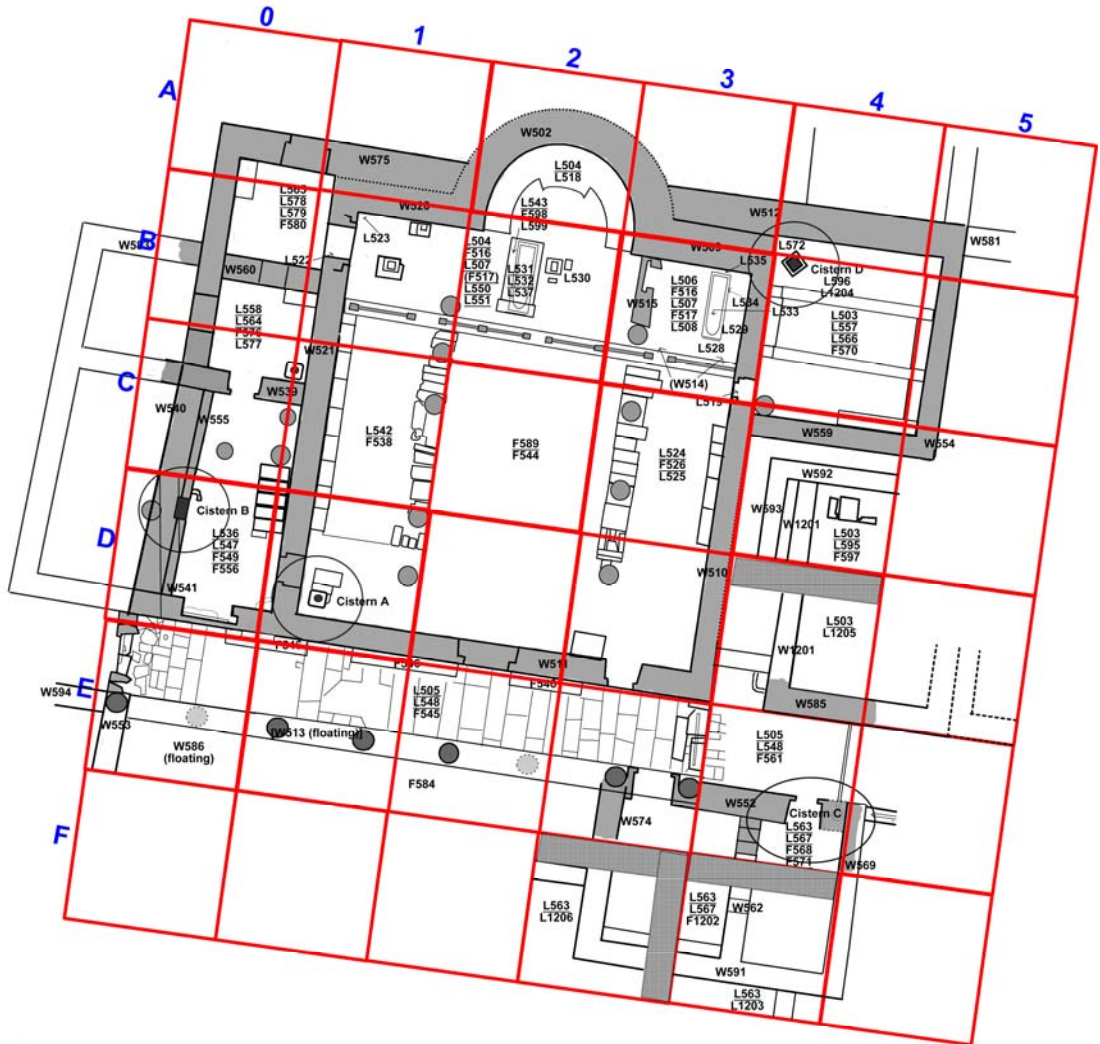

2m

Northeast Church Complex
Hippos 2006



M. Schuler